

IMPERVIOUS SUMMARY			
ITEM	SQUARE FOOT	ACRES	PERCENTAGE OF TOTAL SITE
TOTAL SITE AREA	56061.72	1.2870	N/A
EXISTING BUA	6,841 SF	0.16 AC	12.20 %
EXISTING PERVIOUS	49220.72	1.13 AC	87.80 %
PROPOSED BUILDING (BUA)	10,400 SF	0.24 AC	18.55 %
PROPOSED CONCRETE (BUA)	1,646 SF	0.04 AC	2.94 %
PROPOSED ASPHALT	14,832 SF	0.34 AC	26.46 %
TOTAL BUA	33,719 SF	0.77 AC	60.15 %
TOTAL PERVIOUS	22,342.72 SF	0.51 AC	39.85 %

SITE DATA	
LOCATION:	4850 NC HWY 49 (PIN 5507-56-93030000) HARRISBURG, NC 28075
EXISTING ZONE:	C-1 PROPOSED ZONE: O-1
CONTACT:	HENSONFOLEY (JAY HENSON) 704-875-1615
ITEM	PROVIDED
MIN. FRONT SETBACK	30 FT
MIN. SIDE SETBACK	0 FT
MIN. REAR SETBACK	0 FT
MAX. BUILDING HEIGHT	48'
SOIL TYPE	MKB
BUFFERS	
PERIMETER LANDSCAPING TYPE A BUFFERS 1 TREE PER 100' 1 SHRUB PER 50' 40 POINTS PER 100 LF	

ZONING CODE SUMMARY	
ITEM	PROVIDED
SITE AREA	1.287 AC
BUILDING SIZE	BUILDING A: 3,200 SF (4 UNITS) BUILDING B: 3,200 SF (4 UNITS) BUILDING C: 4,000 SF (5 UNITS) BUILDING TOTAL: 10,400 SF (13 UNITS)
BUILDING DENSITY	10 UNITS PER ACRE
FAR	10,400/ 1.287 AC (56,061 SF) = 0.18
PARKING SPACES REQUIRED	26 @ 2 PER UNIT (13 UNITS)
PARKING SPACES PROVIDED	26 SPACES
BIKE PARKING REQUIRED	NONE
MIN. DRIVE AISLE WIDTH	AS NOTED
MIN. DRIVEWAY RADIUS	AS NOTED

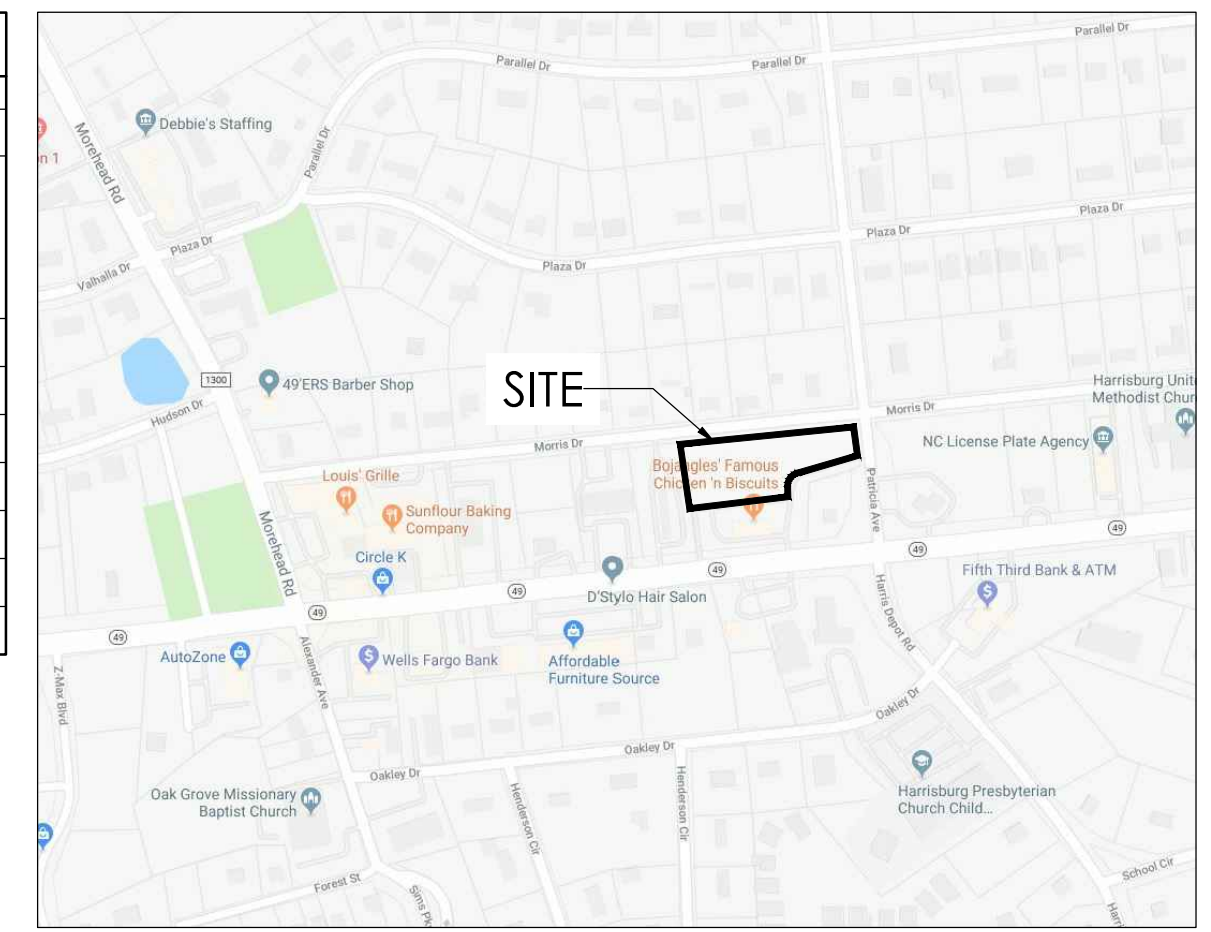

HensonFoley
 Landscape Architecture | Civil Engineering | Surveying
 8712 Lindholm Dr Suite 202A, Huntersville, NC 28078
 p: 704.875.1615 | f: 704.875.0959 | www.hensonfoley.com
 NC ENGINEERING BOARD LICENSE # C-3781
 NC LAND SURVEYING BOARD LICENSE # PL 389

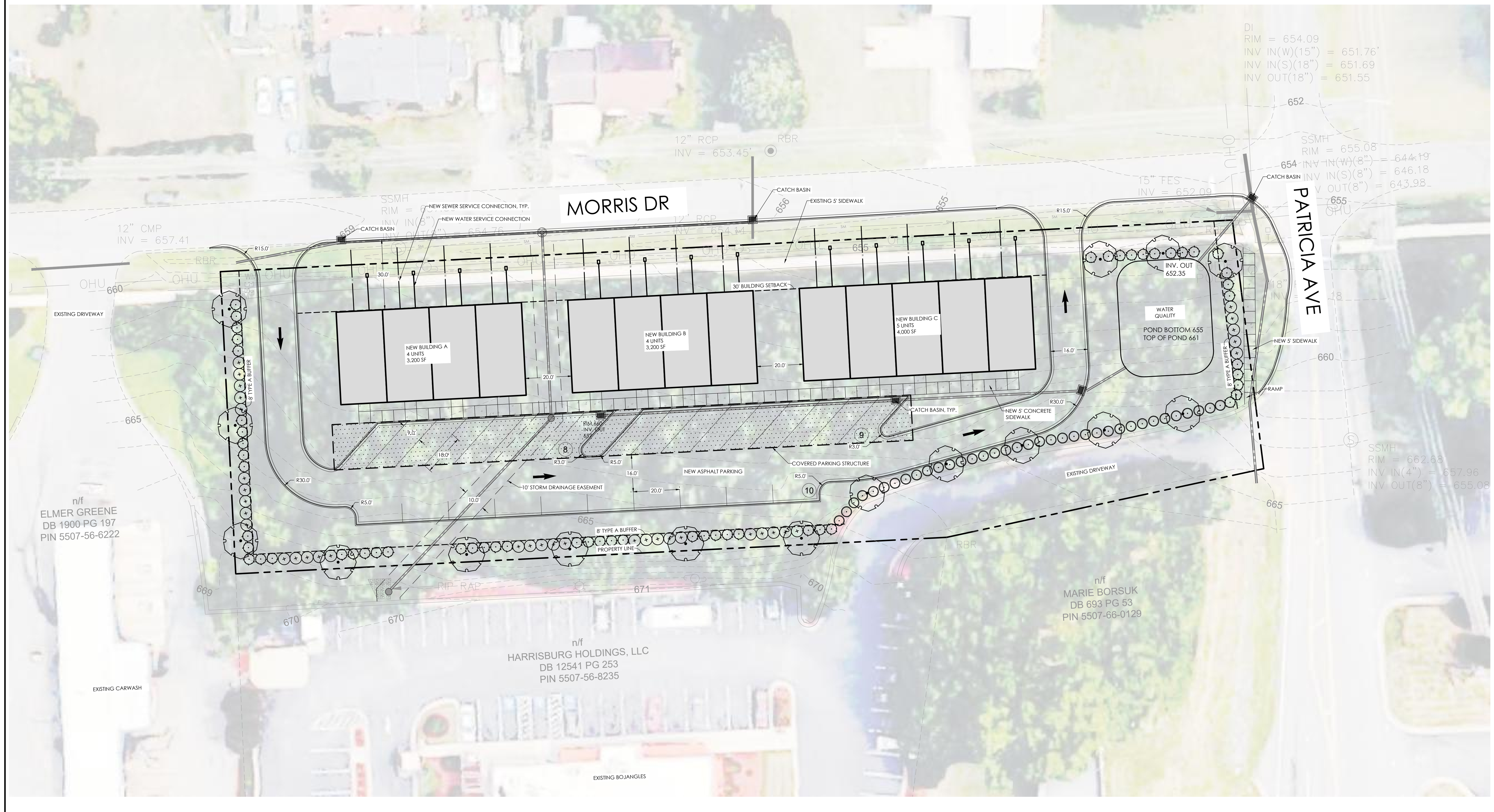

North Arrow
 GRAPHIC SCALE 1"=20 FT
 Professional Engineer Seal for Jay Henson, State of North Carolina, License No. C-3781, expires 12/31/2023.

HARRISBURG TOWNHOMES
 PIN # 5507-56-93030000
 4850 HWY 49 S, HARRISBURG, NC 28075
SITE PLAN ALT 1

REVISIONS:

NO.	DATE	DESCRIPTION